

Rubber Sleeper Pad	
Part Number	Description
T3600MTP4	Rubber Sleeper Pad, 4"x1/4"x10'
T3600MTP8	Rubber Sleeper Pad, 8"x1/4"x10'

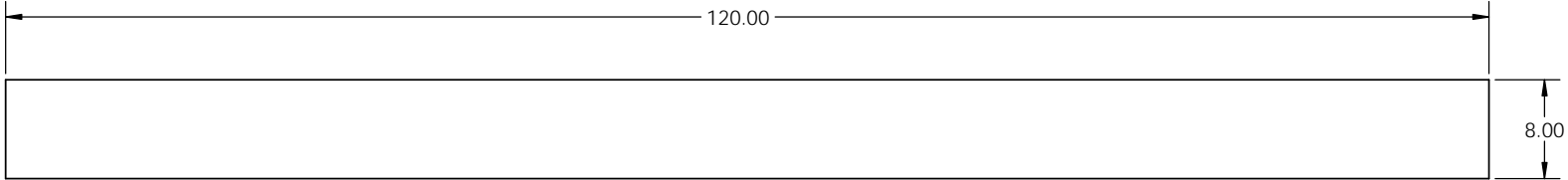
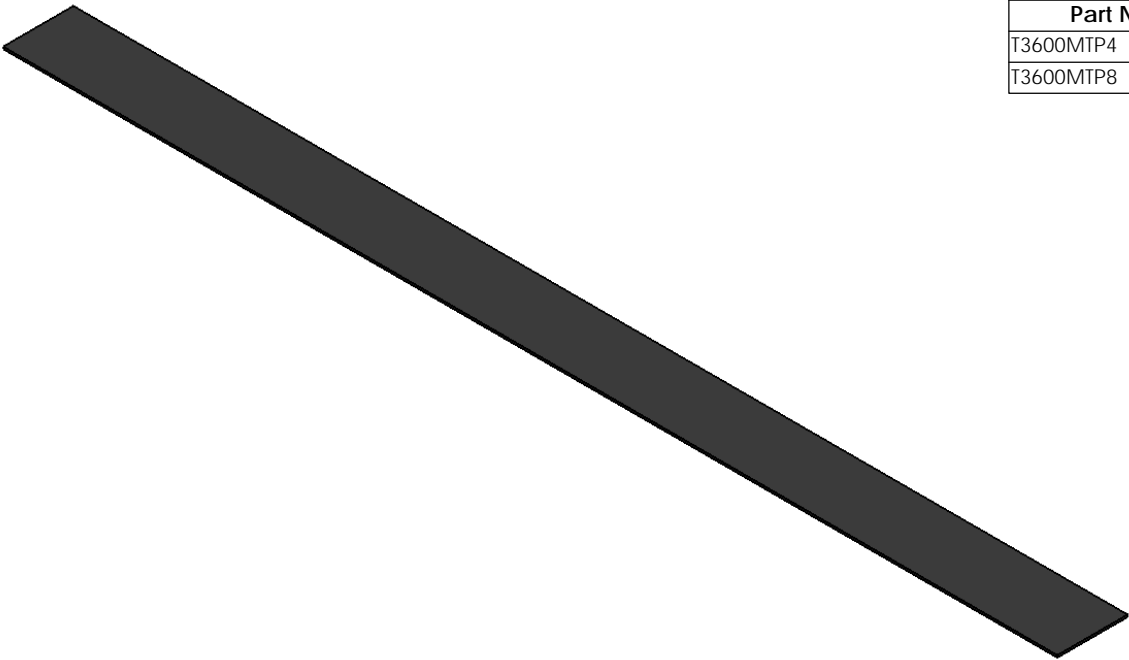

KENWOOD TELECOM
 3431 Newis Park Ave., Acworth, GA 30201
 (800) 399-0900 (770) 974-7000 fax

PROPRIETARY AND CONFIDENTIAL
 THE INFORMATION CONTAINED IN THIS DRAWING IS THE SOLE PROPERTY OF KENWOOD TELECOM. ANY REPRODUCTION IN PART OR AS A WHOLE WITHOUT THE WRITTEN PERMISSION OF KENWOOD TELECOM IS PROHIBITED.

UNLESS OTHERWISE SPECIFIED:	
DIMENSIONS ARE IN INCHES	
TOLERANCES:	
FRACTIONAL: $\pm 1/32$	
ANGULAR: $\pm 2^\circ$	
ONE PLACE DECIMAL: $\pm .06$	
TWO PLACE DECIMAL: $\pm .03$	
THREE PLACE DECIMAL: $\pm .010$	
INTERPRET GEOMETRIC TOLERANCING PER:	
MATERIAL:	Rubber
FINISH:	
NEXT ASSY:	USED ON:
APPLICATION:	DO NOT SCALE DRAWING

NAME	DATE
PQ	10/28/14
CHECKED	
ENG APPR.	
MFG APPR.	
Q.A.	
COMMENTS:	

KENWOOD TELECOM

TITLE:
Rubber Sleeper Pad

SIZE	DWG. NO.	REV
B	T3600MT	

SCALE: 1:10 WEIGHT: 10.05 SHEET 1 OF 1